

# Versatile. Compact. Functional.

The Printer for Bigger Creativity

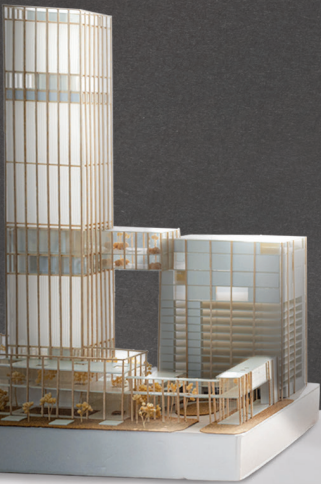

PRINT  
UP TO **A3**

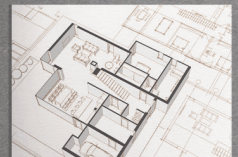
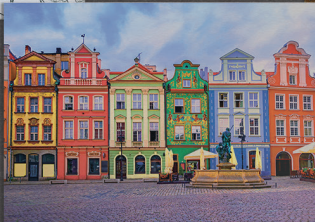

Sharp Print Output



Large Paper Capacity



Highly Durable



### **HIGH VOLUME RE-IMAGINED**

Experience the versatile print formats with volumes at an incredibly cost efficient yield. With Brother's high-yield InkBenefit cartridges, get yields up to 3,000\*\* pages for black and 1,500\*\* pages for colour. Cost has never been more efficient.



### **VIVID PROFESSIONAL PRINTS**

Great ideas materialise with quality prints. The new fast-drying pigment-based ink delivers superior print quality with high black density and true-to-life colours, ensuring each copy stays crisp, sharp and vivid.

\*\* Approximate cartridge yield is declared in accordance with ISO/IEC 24711

  
**inkbenefit**

INKJET MULTI-FUNCTION CENTRE SERIES

# A BIGGER CANVAS OF CREATIVITY

The Multi-Function Centre that delivers all your details. Think big, be adventurous and productive. Ideas come and go, have the freedom to express them in bigger media sizes, in larger volume and at a fraction of the cost.



## WIDE MEDIA SIZES

Leave behind cramped spreadsheets, documents and indistinct photos. With A3<sup>†</sup> and long paper support, present your work without losing the details. Whether you are printing large format or small documents, the new Brother Inkjet series ensures your ideas are illustrated brilliantly.

<sup>†</sup> A3 scan, copy and fax capabilities applicable to MFCJ3540DW and MFCJ3940DW



## FASTEST IN ITS CLASS\*

With an impressive First Print Out Time (FPOT) of 4.4 seconds<sup>^^</sup>, 28ipm<sup>^</sup> for black and 28ipm<sup>^</sup> for colour, the new inkjet series ensures that you spend less time waiting for prints, and more time crafting your ideas.



\* Accurate at time of print  
<sup>^</sup> Based on ISO/IEC 24734  
<sup>^^</sup> Based on ISO/IEC 17629

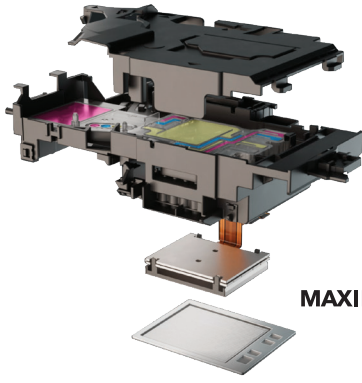

**MAXIDRIVE**

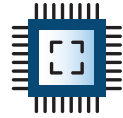

## THE NEXT GENERATION IN PRINT

**MAXIDRIVE** - Brother's patented print chip uses a unique dual transformational piezoelectric system that emits ink at high-power. This greatly enhanced print quality, boost print speed and make machine life more durable.



**3.5" LCD**

## FUNCTIONALITY AT A TAP

Navigate print jobs and printer functions effortlessly with the 3.5" colour LCD touchscreen\*. With built-in Ethernet and wireless capabilities, connect all your devices to one MFC for extra convenience.

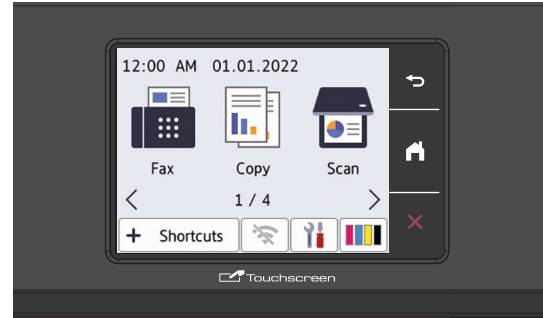

\* Applicable to MFCJ2740DW InkBenefit and MFCJ3940DW InkBenefit



## 600 HIGH CAPACITY TRAYS

**Versatile paper handling increases productivity.** Two paper trays with 500 sheets combined capacity help minimize refills. The trays accept up to A3 paper size to minimize switching between A4 and A3 papers. In addition, the multi-purpose tray holds up to and extra 100 sheets\* of multiple paper types, allowing printing on envelopes, cardstock and other media for diverse printing needs.

\* Applicable to MFCJ2740DW InkBenefit and MFCJ3940DW InkBenefit



## FLEXIBLE CONNECTIVITY



### Brother Mobile Connect App

Print and scan from any mobile devices.



### WebConnect

Print from popular cloud storages without using your computer.



### Brother Cloud Apps

Access innovative cloud-based applications directly on the MFC.

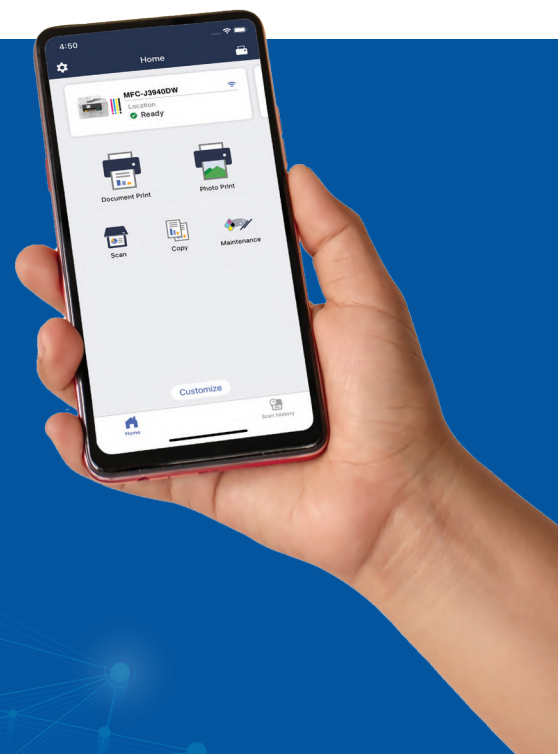



**MFCJ2340DW**  
InkBenefit



**MFCJ2740DW**  
InkBenefit



**MFCJ3540DW**  
InkBenefit



**MFCJ3940DW**  
InkBenefit

Functions	Print, Scan, Copy, Fax, Direct Photo Print, Auto 2-Sided Print, Wireless Network, Wi-Fi Direct, Mobile Print, WebConnect, Brother Apps			
<b>GENERAL</b>				
Memory	256MB			
Display	2.7" LCD Touch Panel	3.5" LCD Touch Panel	2.7" LCD Touch Panel	3.5" LCD Touch Panel
Interface	Hi-Speed USB 2.0			
Wired / Wireless Network	Yes / Yes			
<b>COLOUR PRINT FUNCTION</b>				
Print Speed (Laser Comparable) <sup>i</sup>	Up to 28 ipm (mono) and 28 ipm (colour)			
Print Speed (Fast Mode)	Up to 35 ppm (mono) and 32 ppm (colour)			
First Print Out Time <sup>ii</sup> (FPOT)	4.4 sec (mono) and 4.6 sec (colour)			
Duplex Print Speed <sup>i</sup>	Up to 21 ipm (mono) and 21 ipm (colour)			
Print Resolution	Up to 1200x4800 dpi			
Automatic 2-sided Print	Yes (Up to A4/LTR)		Yes (Up to A3/LGR)	
Borderless Printing	Yes			
Colour Enhancement (Customize colour output via Brother image enhancement)	Yes			
Mobile Print	Brother Mobile Connect, Airprint, Mopria			
WebConnect	Yes			
Wi-Fi Direct	Yes			
Near Field Communication (NFC)	N.A.			Yes
<b>COLOUR COPY FUNCTION</b>				
Maximum Copy Size	Up to A4 / LTR		Up to A3 / LGR	
Copy Speed (Laser Comparable) <sup>iii</sup>	Up to 25 ipm (mono) and 16 ipm (colour)			
Copy Resolution (Colour)	Print: Max. Up to 1200x4800 dpi, Scan: Max. Up to 600x600 dpi			
Auto Duplex Copy	N.A.	Yes (A5, LTR, A4)	N.A.	Yes (LGR, LGL, Folio, LTR, A3, A4, A5, Mexico Legal, India Legal)
Enlargement / Reduction Ratio	25% - 400% in 1% increments			
Background Colour Removal	Yes			
<b>COLOUR SCAN FUNCTION</b>				
Maximum Scan Size	Up to A4		Up to A3	
Duplex Scan	N.A.	Yes	N.A.	Yes (Up to A3 / LGR)
Scan Resolution	Optical: Up to 1,200 x 2,400 dpi (FB) Interpolated: Up to 19,200 x 19,200 dpi (For Windows 7/Windows 8/Window 8.1/10)			
Scanning Speed <sup>iv</sup>	Up to 25 ipm (mono) and 25 ipm (colour)			
"Scan To" Feature	Email, Email server, File, FTP, Image, Media, Network (Window only), OCR			
<b>COLOUR FAX FUNCTION</b>				
Maximum Fax size	Up to A4		Up to A3	
Modem	14.4 kbps		33.6 kbps	
Memory Transmission <sup>v</sup>	Up to 150 pages			
Speed Dials	100x2 numbers <sup>vi</sup>			
Group Dials	Up to 6 groups			
Out of Paper Reception <sup>v</sup>	Up to 150 pages			
Fax Forwarding	Yes (B&W only)			
Internet Fax (Version T37)	Yes			
PC-Fax (Mono)	Sending & Receiving <sup>vii</sup> (USB/Network)			
<b>ADDITIONAL FEATURES</b>				
Brother Apps	Yes			
Secure Function Lock	Yes [Version 3.0] Number of Registerable Users: 100			
<b>DIRECT PHOTO PRINTING</b>				
USB Flash Memory	Yes (JPEG)			
<b>PAPER HANDLING</b>				
Paper Input (Standard Tray)	Up to 250 sheets (80g/m <sup>2</sup> )	Up to 250 sheets (80g/m <sup>2</sup> )	Up to 250 sheets (80g/m <sup>2</sup> )	Up to 250 sheets (80g/m <sup>2</sup> )
Paper Input (Lower Tray)	N.A.	Up to 250 sheets (80g/m <sup>2</sup> )	N.A.	Up to 250 sheets (80g/m <sup>2</sup> )
Paper Input (Multipurpose Tray / Manual Feed Slot)	1 sheet (120g/m <sup>2</sup> )	100 sheets (80g/m <sup>2</sup> )	1 sheet (120g/m <sup>2</sup> )	100 sheets (80g/m <sup>2</sup> )
Paper Output	Up to 100-sheets (up to A4, 80g/m <sup>2</sup> ), Up to 50-sheets (up to A3, 80g/m <sup>2</sup> )			
Automatic Document Feeder	Up to 50 pages (80g/m <sup>2</sup> )			
Paper Handling Sizes (Standard Tray)	<Landscape> A4, LTR, EXE, B5(JIS)* <Portrait> A3, LGR, LGL, Folio, B4(JIS)*, A5, B6(JIS)*, A6, Photo(10x15cm/4x6"), Index card(13x20cm/5x8"), Photo-L(9x13cm/3.5x5"), Photo-2L(13x18cm/5x7"), Com-10, DL Envelope, Monarch, C5, Mexico Legal, India Legal *Only for HK/TW. **Photo paper is available up to A4/LTR.		<Landscape> A4, LTR, EXE, B5(JIS)* <Portrait> A3, LGR, B4(JIS)*, LGL, Folio, A5, B6(JIS)*, A6, Photo(10x15cm/4x6"), Index card(13x20cm/5x8"), Photo-L(9x13cm/3.5x5"), Photo-2L(13x18cm/5x7"), C5, Com-10, DL Envelope, Monarch, Mexico Legal, India Legal *Only for HK/TW	



**MFCJ2340DW**  
InkBenefit



**MFCJ2740DW**  
InkBenefit



**MFCJ3540DW**  
InkBenefit



**MFCJ3940DW**  
InkBenefit

<b>Paper Handling Sizes (Lower Tray)</b>	N.A.	<Landscape> A4, LTR  <Portrait> A3, LGR, B4(JIS)*, LGL, Folio, Mexico Legal, India Legal  *Only for HK/TW	N.A.	<Landscape> A4, LTR  <Portrait> A3, LGR, B4(JIS)*, LGL, Folio, Mexico Legal, India Legal  *Only for HK/TW
<b>Paper Handling Sizes (Manual Feed Slot)</b>	<Landscape> A4, LTR, EXE, B5(JIS)*  <Portrait> A3, B4(JIS)*, LGR, LGL, Folio, A5, B6(JIS)*, A6, Photo(10x15cm/4x6"), Index card(13x20cm/5x8"), Photo-L(9x13cm/3.5x5"), Photo-2L(13x18cm/5x7"), C5, Com-10, DL Envelope, Monarch, Mexico Legal, India Legal  *Only for HK/TW	N.A.	<Landscape> A4, LTR, EXE, B5(JIS)*  <Portrait> A3, LGR, B4(JIS)*, LGL, Folio, A5, B6(JIS)*, A6, Photo(10x15cm/4x6"), Index card(13x20cm/5x8"), Photo-L(9x13cm/3.5x5"), Photo-2L(13x18cm/5x7"), C5, Com-10, DL Envelope, Monarch, Mexico Legal, India Legal  *Only for HK/TW	N.A.
<b>Paper Handling Sizes (Multi-Purpose Tray)</b>	N.A.	<Landscape> A4, LTR, EXE, B5(JIS)*  <Portrait> A3, LGR, B4(JIS)*, LGL, Folio, A5, B6(JIS)*, A6, Photo(10x15cm/4x6"), Index card(13x20cm/5x8"), Photo-L(9x13cm/3.5x5"), Photo-2L(13x18cm/5x7"), Com-10, DL Envelope, Monarch, C5, Mexico Legal, India Legal  *Only for HK/TW	N.A.	<Landscape> A4, LTR, EXE, B5(JIS)*  <Portrait> A3, LGR, B4(JIS)*, LGL, Folio, A5, B6(JIS)*, A6, Photo(10x15cm/4x6"), Index card(13x20cm/5x8"), Photo-L(9x13cm/3.5x5"), Photo-2L(13x18cm/5x7"), Com-10, DL Envelope, Monarch, C5, Mexico Legal, India Legal  *Only for HK/TW
<b>Media Type (Standard Tray)</b>	Plain, Inkjet, Glossy (cast/resin), Recycled *Glossy is available up to A4/LTR		Plain, Inkjet, Glossy(cast/resin), Recycled	
<b>Media Type (Lower Tray)</b>	N.A.	Plain, Recycled	N.A.	Plain, Recycled
<b>Media Type (Manual Feed Slot)</b>	Plain, Inkjet, Glossy, Recycled	N.A.	Plain, Inkjet, Glossy, Recycled	N.A.
<b>Media Type (Multi-Purpose Tray)</b>	N.A.	Plain, Inkjet, Glossy, Recycled	N.A.	Plain, Inkjet, Glossy, Recycled
<b>SUPPORTED OS &amp; SOFTWARE</b>				
<b>Supported Operating Systems</b>	Windows: 7 / 8 / 8.1 / 10 / Server 2008 / Server 2008 R2 / Server 2012 / Server 2012 R2 / 2016 / 2019 Mac: OS 10.14.6/10.15.x/11 <sup>x</sup>			
<b>Network Management Tools</b>	Web Based management, BRAdmin Light <sup>viii</sup>			
<b>SUPPLIES</b>				
<b>Innobella™ Ink Cartridges</b>	Standard Yield LC462 BK: Approximate Yield 550 A4 pages <sup>ix</sup> Standard Yield LC462 C/M/Y: Approximate Yield 550 A4 pages <sup>ix</sup> High Yield LC462XL BK: Approximate Yield 3,000 A4 pages <sup>ix</sup> High Yield LC462XL C/M/Y: Approximate Yield 1,500 A4 pages <sup>ix</sup>			
<b>Brother Paper</b>	BP71GA3: A3 glossy photo paper, BP71GA4: A4 glossy photo paper, BP71GP20: 4x6" glossy photo paper, BP60MA3: A3 matte paper, BP60MA: A4 matte paper, BP60PA3: A3 plain paper, BP60PA: A4 plain paper			
<b>DIMENSIONS &amp; WEIGHT</b>				
<b>Without Carton (W x D x H)</b>	530mm x 398mm x 305mm 17.0 kg	530mm x 398mm x 375mm 20.5 kg	576mm x 477mm x 305mm 19.8 kg	576mm x 477mm x 375mm 23.4 kg

i Based on ISO/IEC 24734. For more information, please refer to [www.brother.com/rd/printspeed](http://www.brother.com/rd/printspeed)

ii Based on ISO/ICE 17629. For more information, please refer to [www.brother.com/rd/printspeed](http://www.brother.com/rd/printspeed)

iii Based on ISO/IEC 24735 for models with Automatic Document Feeder only. For more information, please refer to [www.brother.com/rd/printspeed](http://www.brother.com/rd/printspeed).

iv Based on ISO/IEC 17991

v Based on ITU-T Test Chart No 1/MMR

vi Stores up to 100 address entries. Each entry may have 2 numbers

vii Receiving is for Windows® only

viii Not supported on Mac and Linux. Available for download at <http://support.brother.com>

ix Approximate cartridge yield is declared in accordance with ISO/IEC 24711

x For printing and scanning from Mac, use AirPrint or download iPrint&Scan from Mac App Store. Brother iPrint&Scan application on macOS supports PDF/JPG/BMP and PNG format only. Mac OS driver is not provided.

- Information correct as at the time of publication and may change without prior notice.



Working with you for a better environment  
[www.brotherearth.com](http://www.brotherearth.com)



One-stop centre for free downloadable templates



Brother strongly recommends the use of genuine Brother consumable products only. Benefits include better quality print, greater yields per consumable, protection of your machine from damages and achievement of optimum performance. As a precaution, please note that your machine warranty may not cover any damages arising from the use of non-genuine consumables.